

• In addition to routine checks for each use, PPE should regularly undergo a detailed inspection by a competent person.

Petzl recommends an inspection every 12 months and after any exceptional event in the life of the product.

• PPE inspection should be conducted with the manufacturer's Instructions for Use.

Download the instructions at PETZL.COM.



CONNECTORS

1. Known product history

Any PPE showing unexpected degradation should be quarantined, pending a detailed inspection.

The user should:

- Provide precise information on the usage conditions.
- Report any exceptional event regarding his/her PPE.

(Examples: fall or fall arrest, use or storage at extreme temperatures, modification outside manufacturer's facilities...).

2. Preliminary observations

Verify the presence and legibility of the serial number and the CE mark.

Note: the serial number code on our products is evolving. Two types of code will coexist. See below for details on each serial number code.

Code A:

00 000 AA 0000

Year of manufacture	00
Day of manufacture	0000
Name of Inspector	AA
Incrementation	0000

Code B:

00 A 0000000 000

Year of manufacture	00
Month of manufacture	A
Batch number	0000000
Incrementation	000

Verify that the product lifetime has not been exceeded.

Compare with a new product to verify there are no modifications or missing parts.

3. Inspecting the frame

To properly inspect your connector, it must be removed from any device that conceals any part of the frame: lanyard, energy-absorbing lanyard with STRING, TRAC trolley...

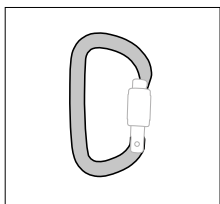

- Check the condition of the frame (marks, cracks, wear, deformation, corrosion...).

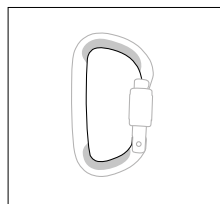

- Check for wear caused by the rope's passage, or by contact with anchors (depth of marks: wear greater than one mm deep is serious, sharp edges start to form...).

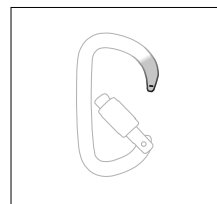

- Check the condition of the nose (marks, wear, cracks, deformation...).

4. Inspecting the gate (depending on connector model)

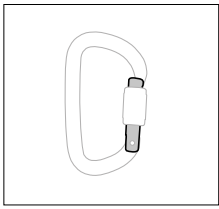

- Check the condition of the gate (marks, wear, deformation, corrosion, cracks...).

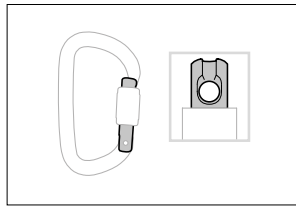

- Verify the Keylock hole is clear.

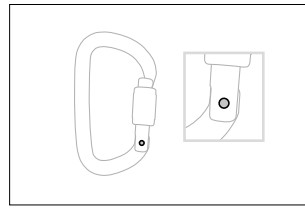

- Check the condition of the rivet (cracks, deformation, corrosion...).

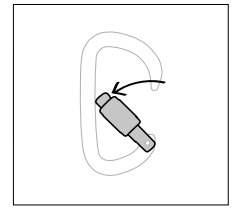

- Manually verify that the gate opens completely.

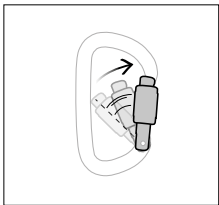

- Verify that the gate closes automatically, that the return spring works, and that the gate and nose align properly.

5. Checking the manual locking sleeve (depending on connector model)

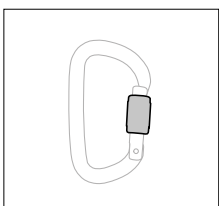

- Check the condition of the locking sleeve (marks, deformation, corrosion, cracks...).

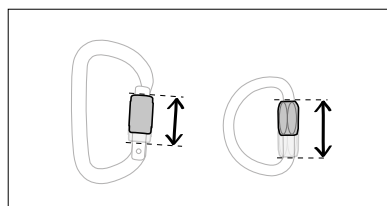

- Verify that the locking sleeve can completely lock and unlock the connector. If necessary, clean with soap and water and lubricate lightly (ex. graphite powder). Verify that the locking sleeve cannot be turned when in its normal stop position (i.e. stripped threads).

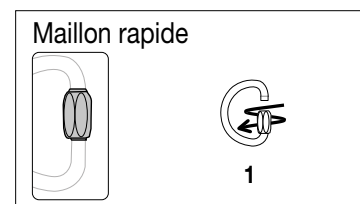
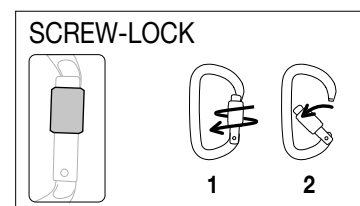

6. Checking the automatic locking sleeve (depending on connector model)

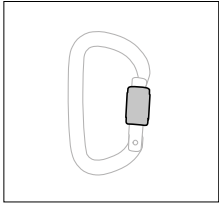

- Check the condition of the locking sleeve (marks, deformation, corrosion, cracks...).

- Verify that the unlocking system works properly, according to the opening method described in your connector's Instructions for Use.

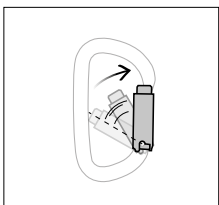
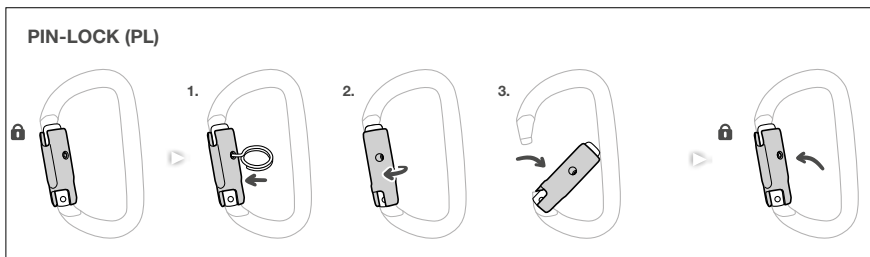
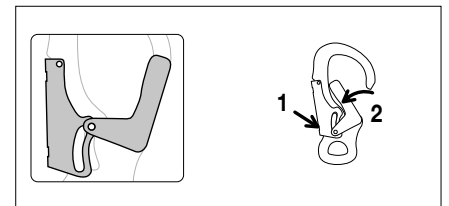
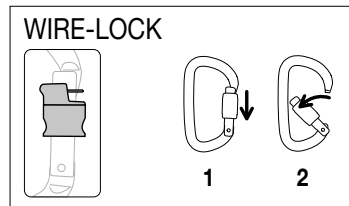
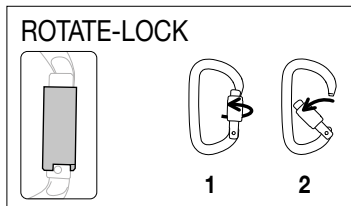
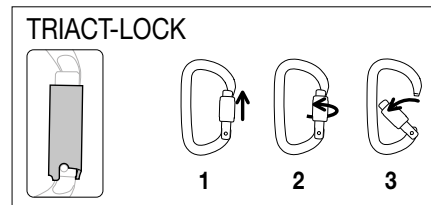
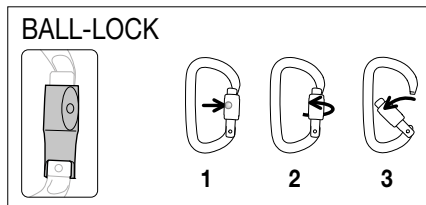

- Check that the connector locks automatically when you release the gate and the sleeve.
If necessary, clean with soap and water and lubricate lightly (ex. graphite powder).

7. Gate system on OPEN connectors

- Do the PPE inspection in a suitable location to avoid losing the spacer or screw.

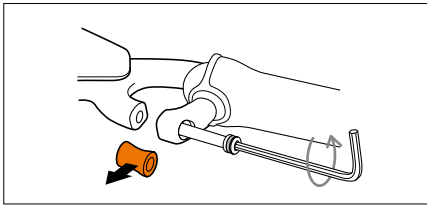

- Make sure the O-ring is present on the screw. This O-ring helps prevent the screw from loosening in the event it is not properly tightened. If the O-ring is missing, contact Petzl after-sales service.

- Verify the absence of any marks, cracks, deformation or corrosion on the spacer, the screw and the threads.

- Securely tighten the screw to the torque specified in the OPEN connector's Instructions for Use, verify there is no play in the spacer.

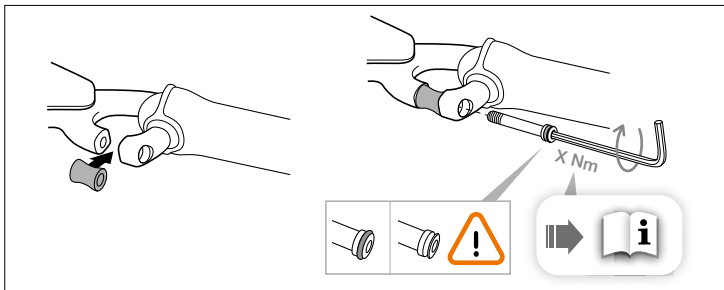

Appendix 1. Examples of connectors that should be retired.

• Mark on the frame



• Cracked frame



• Corrosion



• Poor gate/nose alignment



• Defective locking system



• Cracked gate



• Corrosion



• Worn gate and frame



• Broken locking sleeve



• Defective locking system



• Corrosion



• Defective locking system



• Corrosion



• Frame worn by the rope



• Defective locking system

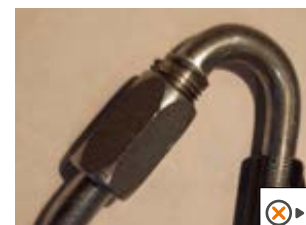

• Cracked gate



• Defective return spring



• Defective return spring



Appendix 1. Examples of connectors that should be retired.

- Defective locking system



- Defective return spring



- Defective locking system

